

LED Aufbauleuchte SL-RGBW

LED surface mtd. luminaire SL-RGBW

LED Maschinenleuchte in Linienform mit 24V Betriebsspannung
LED machine luminaire line shaped with 24V operating voltage.

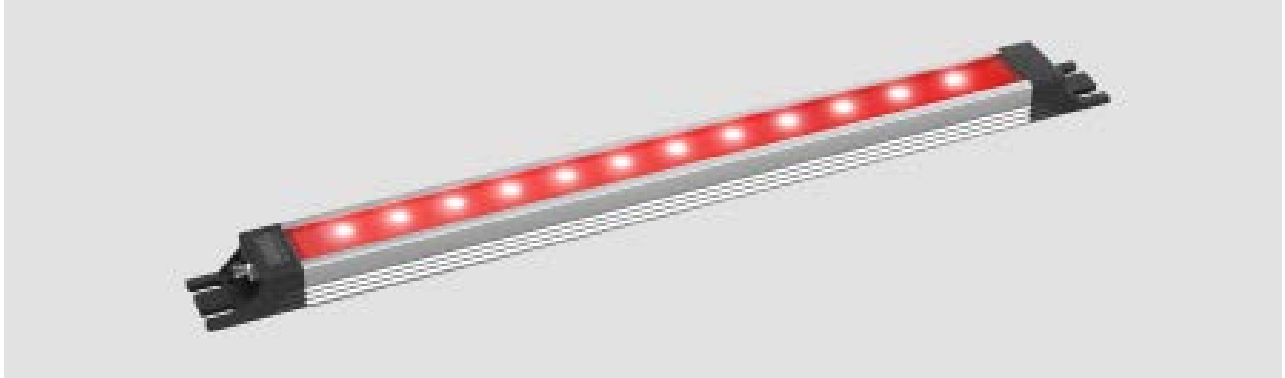

Lichtverteilung | Light distribution

Lichtpunkthöhe | Metering distance: 100cm

LED SL-RGBW 280

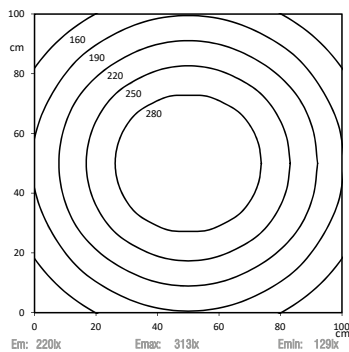

LED SL-RGBW 1120

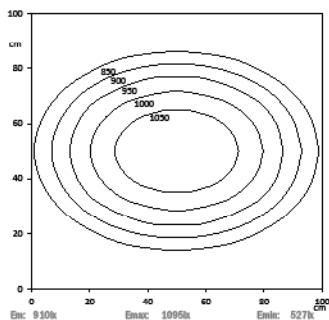

Dimensionierung | Dimensions

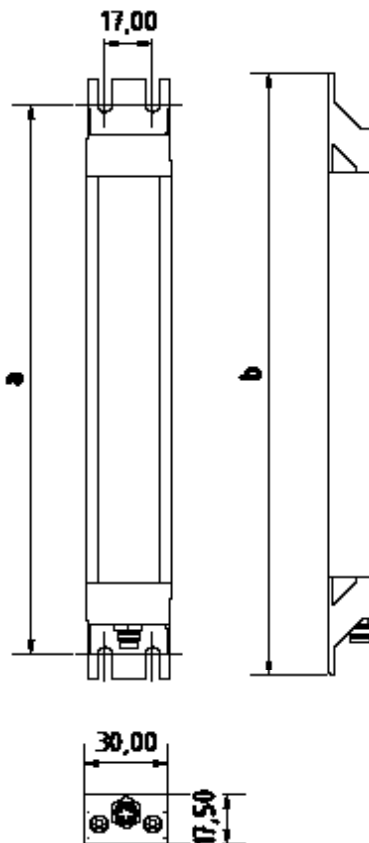

7 mögliche Farben | 7 possible color

red
green
blue
red+blue=magenta
red+green= yellow
blue+green= cyan
white

Technische Daten | Technical data

Anschlusswert: Connection value:	24V DC 24V DC
Anschluss Connection type:	Steckverbinder M8 5pol. B codiert connector M8 5pol. B coded
Gehäuse: Housing:	Aluminium eloxiert, Kunststoffhalterung aluminium anodized, plastic mounting
Schutzart: Protection rating:	PMMA = IP40 PUd = 69K PMMA = IP40 PUd = IP69K
Schutzklasse: Protection class:	III III
Abdeckung: Cover:	PMMA diffus, PU diffus PMMA diffuse, PU diffuse
Farbtreue: Color rendering:	Ra / CRI ≥ 80 Ra / CRI ≥ 80
Lebensdauer: Service life:	min. 60 000h min. 60 000h
Max. Umgebungstemperatur: Max. ambient temperature:	-20°C / +45°C -20°C / +45°C
Optik: Optics:	120° Optik 120° optics
Belegung: Pin assignment:	1 = +24V ws wh 2 = +24V rt rd 3 = +24V gn ge 4 = +24V bl bl 5 = 0V

Normen / Approbationen Standards / Approvals

DIN EN 55015 (EMV)
DIN EN 61547 (EMV)
DIN EN 60598-1
DIN EN 62471



Nomenklatur Nomenclature	Katalognr. Catalogue no.	Länge Length	Abdeckung Cover	Lichtstrom Luminous flux	Leistungsaufnahme Power consumption	Lichtfarbe Light temp.
-----------------------------	-----------------------------	-----------------	--------------------	-----------------------------	--	---------------------------

Starre Halterung | static mounting

LED SL-RGBW 280 S-PMMA _d -M8-57	15070714	a: 336,0mm b: 355,0mm	PMMA diffus PMMA diffuse	ca. 1206 lm	R: 1,6W G: 1,0W B: 0,8W W: 8,1W	5.700K
LED SL-RGBW 280 S-PU _d -M8-65	15070974	a: 336,0mm b: 355,0mm	PU _d diffus PU _d diffuse	ca. 1206 lm	R: 1,6W G: 1,0W B: 0,8W W: 8,1W	6.500K
LED SL-RGBW 560 S-PMMA _d -M8-57	15070715	a: 616,0mm b: 635,0mm	PMMA diffus PMMA diffuse	ca. 2412 lm	R: 3,1W G: 2,0W B: 1,6W W: 16,3W	5.700K
LED SL-RGBW 560 S-PU _d -M8-65	15070975	a: 616,0mm b: 635,0mm	PU _d diffus PU _d diffuse	ca. 2412 lm	R: 3,1W G: 2,0W B: 1,6W W: 16,3W	6.500K
LED SL-RGBW 840 S-PMMA _d -M8-57	15070716	a: 896,0mm b: 915,0mm	PMMA diffus PMMA diffuse	ca. 3618 lm	R: 4,7W G: 3,0W B: 2,5W W: 24,4W	5.700K
LED SL-RGBW 840 S-PU _d -M8-65	15070976	a: 896,0mm b: 915,0mm	PU _d diffus PU _d diffuse	ca. 3618 lm	R: 4,7W G: 3,0W B: 2,5W W: 24,4W	6.500K
LED SL-RGBW 1120 S-PMMA _d -M8-57	15070973	a: 1176,0mm b: 1195,0mm	PMMA diffus PMMA diffuse	ca. 4824 lm	R: 6,2W G: 3,9W B: 3,3W W: 32,6W	5.700K
LED SL-RGBW 1120 S-PU _d -M8-65	15070977	a: 1176,0mm b: 1195,0mm	PU _d diffus PU _d diffuse	ca. 4824 lm	R: 6,2W G: 3,9W B: 3,3W W: 32,6W	6.500K
LED SL-RGBW 1400 S-PMMA _d -M8-57	15071026	a: 1456,0mm b: 1475,0mm	PMMA diffus PMMA diffuse	ca. 3618 lm	R: 8,0W G: 5,0W B: 4,0W W: 40,5W	5.700K
LED SL-RGBW 1400 S-PU _d -M8-65	15071027	a: 1456,0mm b: 1475,0mm	PU _d diffus PU _d diffuse	ca. 3618 lm	R: 8,0W G: 5,0W B: 4,0W W: 40,5W	6.500K

Starre Halterung mit zweitem Flansch zum Durchschleifen | static mounting with second flange for loop through

LED SL-RGBW 280 S-PMMA _d -M8D-57	15070717	a: 336,0mm b: 355,0mm	PMMA diffus PMMA diffuse	ca. 1206 lm	R: 1,6W G: 1,0W B: 0,8W W: 8,1W	5.700K
LED SL-RGBW 280 S-PU _d -M8D-65	15070978	a: 336,0mm b: 355,0mm	PU _d diffus PU _d diffuse	ca. 1206 lm	R: 1,6W G: 1,0W B: 0,8W W: 8,1W	6.500K
LED SL-RGBW 560 S-PMMA _d -M8D-57	15070718	a: 616,0mm b: 635,0mm	PMMA diffus PMMA diffuse	ca. 2412 lm	R: 3,1W G: 2,0W B: 1,6W W: 16,3W	5.700K
LED SL-RGBW 560 S-PU _d -M8D-65	15070979	a: 616,0mm b: 635,0mm	PU _d diffus PU _d diffuse	ca. 2412 lm	R: 3,1W G: 2,0W B: 1,6W W: 16,3W	6.500K
LED SL-RGBW 840 S-PMMA _d -M8D-57	15070921	a: 896,0mm b: 915,0mm	PMMA diffus PMMA diffuse	ca. 3618 lm	R: 4,7W G: 3,0W B: 2,5W W: 24,4W	5.700K
LED SL-RGBW 840 S-PU _d -M8D-65	15070925	a: 896,0mm b: 915,0mm	PU _d diffus PU _d diffuse	ca. 3618 lm	R: 4,7W G: 3,0W B: 2,5W W: 24,4W	6.500K

Technische Änderungen vorbehalten. Lichtstrom und Lichtfarbe können variieren.
Subject to technical changes. The luminous flux and Light temp. may vary.